

MOLDED ACETAL DOWELS

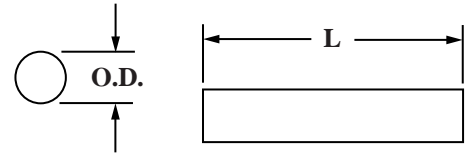

Part Number: C60 + Code

CODE	OD	LENGTH
001	.047	1/8
002	.047	1/4
003	.047	3/8
004	.047	1/2
005	.062	1/8
006	.062	1/4
007	.062	3/8
008	.062	1/2
009	.093	1/8
010	.093	1/4
011	.093	3/8
012	.093	1/2

CODE	OD	LENGTH
013	.125	1/8
014	.125	3/16
015	.125	1/4
016	.125	3/8
017	.125	1/2
018	.187	1/8
019	.187	1/4
020	.187	3/8
021	.187	1/2
022	.187	3/4
023	.245	1-1/4
024	.210	1/2

CODE	OD	LENGTH
025	.250	1/8
026	.250	1/4
027	.250	3/8
028	.250	1/2
029	.250	3/4
030	.312	1/8
031	.312	1/4
032	.312	3/8
033	.312	1/2
034	.312	5/8
035	.312	3/4
036	.437	1/4

STANDARD NYLON SPACERS

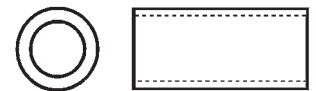

Part Number: C30 + Code

CODE	SCREW SIZE	ID	OD	LENGTH
001	2	.091	3/16	1/8
002	2	.091	3/16	3/16
003	2	.091	3/16	1/4
004	2	.091	3/16	5/16
005	2	.091	3/16	3/8
006	2	.091	3/16	7/16
007	2	.091	3/16	1/2
008	2	.091	3/16	9/16
009	2	.091	3/16	5/8
010	2	.091	3/16	11/16
011	2	.091	3/16	3/4
012	2	.091	3/16	13/16

CODE	SCREW SIZE	ID	OD	LENGTH
013	2	.091	3/16	7/8
014	2	.091	3/16	15/16
015	2	.091	3/16	1
016	4	.115	3/16	1/8
017	4	.115	3/16	3/16
018	4	.115	3/16	1/4
019	4	.115	3/16	5/16
020	4	.115	3/16	3/8
021	4	.115	3/16	7/16
022	4	.115	3/16	1/2
023	4	.115	3/16	9/16
024	4	.115	3/16	5/8

- 5 different outside diameters for #2, 4, 6, 8, 10 & 1/4 screws
- Lengths from 1/8" to 1"
- Tolerances: OD ± .010, ID ± .005, length ± .015