

MOLDED ACETAL DOWELS

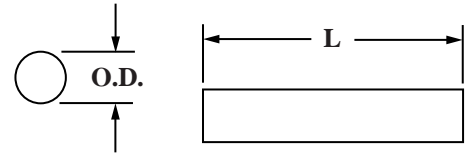

Part Number: C60 + Code

CODE	OD	LENGTH
001	.047	1/8
002	.047	1/4
003	.047	3/8
004	.047	1/2
005	.062	1/8
006	.062	1/4
007	.062	3/8
008	.062	1/2
009	.093	1/8
010	.093	1/4
011	.093	3/8
012	.093	1/2

CODE	OD	LENGTH
013	.125	1/8
014	.125	3/16
015	.125	1/4
016	.125	3/8
017	.125	1/2
018	.187	1/8
019	.187	1/4
020	.187	3/8
021	.187	1/2
022	.187	3/4
023	.245	1-1/4
024	.210	1/2

CODE	OD	LENGTH
025	.250	1/8
026	.250	1/4
027	.250	3/8
028	.250	1/2
029	.250	3/4
030	.312	1/8
031	.312	1/4
032	.312	3/8
033	.312	1/2
034	.312	5/8
035	.312	3/4
036	.437	1/4

STANDARD NYLON SPACERS

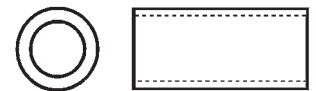

Part Number: C30 + Code

CODE	SCREW SIZE	ID	OD	LENGTH
001	2	.091	3/16	1/8
002	2	.091	3/16	3/16
003	2	.091	3/16	1/4
004	2	.091	3/16	5/16
005	2	.091	3/16	3/8
006	2	.091	3/16	7/16
007	2	.091	3/16	1/2
008	2	.091	3/16	9/16
009	2	.091	3/16	5/8
010	2	.091	3/16	11/16
011	2	.091	3/16	3/4
012	2	.091	3/16	13/16

CODE	SCREW SIZE	ID	OD	LENGTH
013	2	.091	3/16	7/8
014	2	.091	3/16	15/16
015	2	.091	3/16	1
016	4	.115	3/16	1/8
017	4	.115	3/16	3/16
018	4	.115	3/16	1/4
019	4	.115	3/16	5/16
020	4	.115	3/16	3/8
021	4	.115	3/16	7/16
022	4	.115	3/16	1/2
023	4	.115	3/16	9/16
024	4	.115	3/16	5/8

- 5 different outside diameters for #2, 4, 6, 8, 10 & 1/4 screws
- Lengths from 1/8" to 1"
- Tolerances: OD ± .010, ID ± .005, length ± .015

Part Number: C30 + Code (CONTINUED)

CODE	SCREW SIZE	ID	OD	LENGTH
025	4	.115	3/16	11/16
026	4	.115	3/16	3/4
027	4	.115	3/16	13/16
028	4	.115	3/16	7/8
029	4	.115	3/16	15/16
030	4	.115	3/16	1
031	2	.091	1/4	1/8
032	2	.091	1/4	3/16
033	2	.091	1/4	1/4
034	2	.091	1/4	5/16
035	2	.091	1/4	3/8
036	2	.091	1/4	7/16
037	2	.091	1/4	1/2
038	2	.091	1/4	9/16
039	2	.091	1/4	5/8
040	2	.091	1/4	11/16
041	2	.091	1/4	3/4
042	2	.091	1/4	13/16
043	2	.091	1/4	7/8
044	2	.091	1/4	15/16
045	2	.091	1/4	1
046	4	.115	1/4	1/8
047	4	.115	1/4	3/16
048	4	.115	1/4	1/4
049	4	.115	1/4	5/16
050	4	.115	1/4	3/8
051	4	.115	1/4	7/16
052	4	.115	1/4	1/2
053	4	.115	1/4	9/16
054	4	.115	1/4	5/8
055	4	.115	1/4	11/16
056	4	.115	1/4	3/4
057	4	.115	1/4	13/16
058	4	.115	1/4	7/8
059	4	.115	1/4	15/16
060	4	.115	1/4	1
061	6	.140	1/4	1/8
062	6	.140	1/4	3/16
063	6	.140	1/4	1/4
064	6	.140	1/4	5/16
065	6	.140	1/4	3/8

CODE	SCREW SIZE	ID	OD	LENGTH
066	6	.140	1/4	7/16
067	6	.140	1/4	1/2
068	6	.140	1/4	9/16
069	6	.140	1/4	5/8
070	6	.140	1/4	11/16
071	6	.140	1/4	3/4
072	6	.140	1/4	13/16
073	6	.140	1/4	7/8
074	6	.140	1/4	15/16
075	6	.140	1/4	1
076	8	.171	1/4	1/8
077	8	.171	1/4	3/16
078	8	.171	1/4	1/4
079	8	.171	1/4	5/16
080	8	.171	1/4	3/8
081	8	.171	1/4	7/16
082	8	.171	1/4	1/2
083	8	.171	1/4	9/16
084	8	.171	1/4	5/8
085	8	.171	1/4	11/16
086	8	.171	1/4	3/4
087	8	.171	1/4	13/16
088	8	.171	1/4	7/8
089	8	.171	1/4	15/16
090	8	.171	1/4	1
091	4	.115	5/16	1/8
092	4	.115	5/16	3/16
093	4	.115	5/16	1/4
094	4	.115	5/16	5/16
095	4	.115	5/16	3/8
096	4	.115	5/16	7/16
097	4	.115	5/16	1/2
098	4	.115	5/16	9/16
099	4	.115	5/16	5/8
100	4	.115	5/16	11/16
101	4	.115	5/16	3/4
102	4	.115	5/16	13/16
103	4	.115	5/16	7/8
104	4	.115	5/16	15/16
105	4	.115	5/16	1
106	6	.140	5/16	1/8

Part Number: C30 + Code (CONTINUED)

CODE	SCREW SIZE	ID	OD	LENGTH
107	6	.140	5/16	3/16
108	6	.140	5/16	1/4
109	6	.140	5/16	5/16
110	6	.140	5/16	3/8
111	6	.140	5/16	7/16
112	6	.140	5/16	1/2
113	6	.140	5/16	9/16
114	6	.140	5/16	5/8
115	6	.140	5/16	11/16
116	6	.140	5/16	3/4
117	6	.140	5/16	13/16
118	6	.140	5/16	7/8
119	6	.140	5/16	15/16
120	6	.140	5/16	1
121	8	.171	5/16	1/8
122	8	.171	5/16	3/16
123	8	.171	5/16	1/4
124	8	.171	5/16	5/16
125	8	.171	5/16	3/8
126	8	.171	5/16	7/16
127	8	.171	5/16	1/2
128	8	.171	5/16	9/16
129	8	.171	5/16	5/8
130	8	.171	5/16	11/16
131	8	.171	5/16	3/4
132	8	.171	5/16	13/16
133	8	.171	5/16	7/8
134	8	.171	5/16	15/16
135	8	.171	5/16	1
136	10	.194	5/16	1/8
137	10	.194	5/16	3/16
138	10	.194	5/16	1/4
139	10	.194	5/16	5/16
140	10	.194	5/16	3/8
141	10	.194	5/16	7/16
142	10	.194	5/16	1/2
143	10	.194	5/16	9/16
144	10	.194	5/16	5/8
145	10	.194	5/16	11/16
146	10	.194	5/16	3/4
147	10	.194	5/16	13/16

CODE	SCREW SIZE	ID	OD	LENGTH
148	10	.194	5/16	7/8
149	10	.194	5/16	15/16
150	10	.194	5/16	1
151	6	.140	3/8	1/8
152	6	.140	3/8	3/16
153	6	.140	3/8	1/4
154	6	.140	3/8	5/16
155	6	.140	3/8	3/8
156	6	.140	3/8	7/16
157	6	.140	3/8	1/2
158	6	.140	3/8	9/16
159	6	.140	3/8	5/8
160	6	.140	3/8	11/16
161	6	.140	3/8	3/4
162	6	.140	3/8	13/16
163	6	.140	3/8	7/8
164	6	.140	3/8	15/16
165	6	.140	3/8	1
166	8	.171	3/8	1/8
167	8	.171	3/8	3/16
168	8	.171	3/8	1/4
169	8	.171	3/8	5/16
170	8	.171	3/8	3/8
171	8	.171	3/8	7/16
172	8	.171	3/8	1/2
173	8	.171	3/8	9/16
174	8	.171	3/8	5/8
175	8	.171	3/8	11/16
176	8	.171	3/8	3/4
177	8	.171	3/8	13/16
178	8	.171	3/8	7/8
179	8	.171	3/8	15/16
180	8	.171	3/8	1
181	10	.194	3/8	1/8
182	10	.194	3/8	3/16
183	10	.194	3/8	1/4
184	10	.194	3/8	5/16
185	10	.194	3/8	3/8
186	10	.194	3/8	7/16
187	10	.194	3/8	1/2
188	10	.194	3/8	9/16

Part Number: C30 + Code (CONTINUED)

CODE	SCREW SIZE	ID	OD	LENGTH
189	10	.194	3/8	5/8
190	10	.194	3/8	11/16
191	10	.194	3/8	3/4
192	10	.194	3/8	13/16
193	10	.194	3/8	7/8
194	10	.194	3/8	15/16
195	10	.194	3/8	1
196	6	.140	1/2	1/8
197	6	.140	1/2	3/16
198	6	.140	1/2	1/4
199	6	.140	1/2	5/16
200	6	.140	1/2	3/8
201	6	.140	1/2	7/16
202	6	.140	1/2	1/2
203	6	.140	1/2	9/16
204	6	.140	1/2	5/8
205	6	.140	1/2	11/16
206	6	.140	1/2	3/4
207	6	.140	1/2	13/16
208	6	.140	1/2	7/8
209	6	.140	1/2	15/16
210	6	.140	1/2	1
211	8	.171	1/2	1/8
212	8	.171	1/2	3/16
213	8	.171	1/2	1/4
214	8	.171	1/2	5/16
215	8	.171	1/2	3/8
216	8	.171	1/2	7/16
217	8	.171	1/2	1/2
218	8	.171	1/2	9/16
219	8	.171	1/2	5/8
220	8	.171	1/2	11/16
221	8	.171	1/2	3/4
222	8	.171	1/2	13/16
223	8	.171	1/2	7/8
224	8	.171	1/2	15/16
225	8	.171	1/2	1
226	10	.194	1/2	1/8
227	10	.194	1/2	3/16
228	10	.194	1/2	1/4
229	10	.194	1/2	5/16

CODE	SCREW SIZE	ID	OD	LENGTH
230	10	.194	1/2	3/8
231	10	.194	1/2	7/16
232	10	.194	1/2	1/2
233	10	.194	1/2	9/16
234	10	.194	1/2	5/8
235	10	.194	1/2	11/16
236	10	.194	1/2	3/4
237	10	.194	1/2	13/16
238	10	.194	1/2	7/8
239	10	.194	1/2	15/16
240	10	.194	1/2	1
241	1/4	.257	1/2	1/8
242	1/4	.257	1/2	3/16
243	1/4	.257	1/2	1/4
244	1/4	.257	1/2	5/16
245	1/4	.257	1/2	3/8
246	1/4	.257	1/2	7/16
247	1/4	.257	1/2	1/2
248	1/4	.257	1/2	9/16
249	1/4	.257	1/2	5/8
250	1/4	.257	1/2	11/16
251	1/4	.257	1/2	3/4
252	1/4	.257	1/2	13/16
253	1/4	.257	1/2	7/8
254	1/4	.257	1/2	15/16
255	1/4	.257	1/2	1
256	12	.219	1/2	1/8
257	12	.219	1/2	3/16
258	12	.219	1/2	1/4
259	12	.219	1/2	5/16
260	12	.219	1/2	3/8
261	12	.219	1/2	7/16
262	12	.219	1/2	1/2
263	12	.219	1/2	9/16
264	12	.219	1/2	5/8
265	12	.219	1/2	11/16
266	12	.219	1/2	3/4
267	12	.219	1/2	13/16
268	12	.219	1/2	7/8
269	12	.219	1/2	15/16
270	12	.219	1/2	1

STANDARD LONG NYLON SPACERS

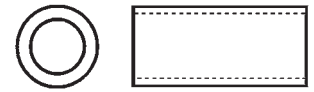

Part Number: C37 + Code

CODE	ID	OD	LENGTH
001	.115	1/4	1-1/16
002	.115	1/4	1-1/8
003	.115	1/4	1-3/16
004	.115	1/4	1-1/4
005	.115	1/4	1-5/16
006	.115	1/4	1-3/8
007	.115	1/4	1-7/16
008	.115	1/4	1-1/2
009	.140	1/4	1-1/16
010	.140	1/4	1-1/8
011	.140	1/4	1-3/16
012	.140	1/4	1-1/4
013	.140	1/4	1-5/16
014	.140	1/4	1-3/8
015	.140	1/4	1-7/16
016	.140	1/4	1-1/2
017	.115	5/16	1-1/16
018	.115	5/16	1-1/8
019	.115	5/16	1-3/16
020	.115	5/16	1-1/4
021	.115	5/16	1-5/16
022	.115	5/16	1-3/8
023	.115	5/16	1-7/16
024	.115	5/16	1-1/2
025	.140	5/16	1-1/16
026	.140	5/16	1-1/8
027	.140	5/16	1-3/16
028	.140	5/16	1-1/4
029	.140	5/16	1-5/16
030	.140	5/16	1-3/8
031	.140	5/16	1-7/16
032	.140	5/16	1-1/2
033	.171	5/16	1-1/16
034	.171	5/16	1-1/8
035	.171	5/16	1-3/16
036	.171	5/16	1-1/4

CODE	ID	OD	LENGTH
037	.171	5/16	1-5/16
038	.171	5/16	1-3/8
039	.171	5/16	1-7/16
040	.171	5/16	1-1/2
041	.194	5/16	1-1/16
042	.194	5/16	1-1/8
043	.194	5/16	1-3/16
044	.194	5/16	1-1/4
045	.194	5/16	1-5/16
046	.194	5/16	1-3/8
047	.194	5/16	1-7/16
048	.194	5/16	1-1/2
049	.140	3/8	1-1/16
050	.140	3/8	1-1/8
051	.140	3/8	1-3/16
052	.140	3/8	1-1/4
053	.140	3/8	1-5/16
054	.140	3/8	1-3/8
055	.140	3/8	1-7/16
056	.140	3/8	1-1/2
057	.171	3/8	1-1/16
058	.171	3/8	1-1/8
059	.171	3/8	1-3/16
060	.171	3/8	1-1/4
061	.171	3/8	1-5/16
062	.171	3/8	1-3/8
063	.171	3/8	1-7/16
064	.171	3/8	1-1/2
065	.194	3/8	1-1/16
066	.194	3/8	1-1/8
067	.194	3/8	1-3/16
068	.194	3/8	1-1/4
069	.194	3/8	1-5/16
070	.194	3/8	1-3/8
071	.194	3/8	1-7/16
072	.194	3/8	1-1/2

SPECIAL NYLON SPACERS

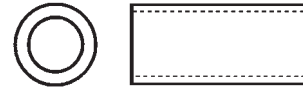

Part Number: C38 + Code

CODE	ID	OD	LENGTH
005	.061	.250	.470
010	.063	.187	.250
015	.063	.187	.300
020	.091	.188	.330
025	.110	.250	.530
030	.115	.187	.156
035	.115	.187	.225
040	.115	.250	.155
045	.115	.250	.530
055	.120	.187	.343
060	.120	.187	.437
065	.120	.250	.800
070	.125	.216	.135
075	.125	.250	.162
080	.125	.250	.250
083	.125	.250	.420
085	.125	.375	.437
090	.126	.197	.276
095	.126	.310	.410
100	.137	.354	.374
105	.140	.187	.187
110	.140	.187	.240
115	.140	.218	.156
120	.140	.250	.160
130	.140	.625	.250
135	.145	.500	.669
140	.147	.250	.220
145	.150	.250	.200
150	.155	.250	.160
155	.160	.500	.125
160	.165	.232	.153
165	.171	.250	.156
170	.171	.250	.405
175	.171	.250	.650

CODE	ID	OD	LENGTH
180	.171	.375	.203
190	.180	.400	.140
195	.183	.312	.124
199	.186	.316	.203
200	.187	.312	.187
205	.187	.312	.215
210	.187	.437	.375
215	.187	.625	.125
220	.187	1.000	.250
225	.188	.312	.300
230	.188	.688	.500
234	.190	.463	.312
235	.191	.375	.217
238	.191	.625	.250
240	.192	.250	.145
245	.192	.375	.156
255	.192	.625	.250
270	.195	.750	.750
275	.200	.750	.187
280	.203	.500	.130
285	.204	.354	.137
290	.205	.500	.510
295	.217	.325	.135
300	.217	.325	.200
305	.219	.375	.250
310	.219	.500	.719
315	.220	.748	.252
320	.220	.748	.625
325	.222	.313	.238
330	.222	.379	.906
335	.225	1.000	.500
340	.236	.354	.224
345	.250	.370	.182
350	.250	.375	.220

SPECIAL NYLON SPACERS

Part Number: C38 + Code

CODE	ID	OD	LENGTH
399	.230	.375	.925
386	.250	1.000	.125
355	.250	.562	.562
360	.250	.625	.375
365	.250	.625	.640
370	.250	.750	.250
375	.250	.750	.312
380	.250	.750	.125
425	.250	.750	.187
385	.250	.765	.125
389	.252	.375	.375
390	.253	.443	.125
395	.256	.377	.785
400	.256	.575	.162
404	.257	.375	1.250
405	.257	.500	.359
410	.257	.750	1.000
415	.260	.625	.250
414	.265	.375	.750
418	.265	.375	.500
419	.265	.375	.375
420	.265	.595	.130
430	.270	.625	.218
435	.280	.500	.250
436	.281	.613	.500
440	.300	.500	.187
445	.312	.437	.187
450	.312	.687	.250
455	.312	.750	.125
460	.314	.590	.359
465	.314	.750	.313
470	.315	.687	.250
475	.317	.500	.337
476	.317	.880	.125
480	.323	.437	.187

CODE	ID	OD	LENGTH
485	.323	.625	.187
490	.325	.480	.250
495	.325	.480	1.250
500	.326	.610	.178
505	.330	1.250	.540
510	.339	.770	.320
515	.343	1.000	.125
520	.343	1.000	.312
525	.344	1.000	.187
530	.350	.750	.685
531	.375	.500	.625
534	.375	.500	.437
535	.375	.580	.380
536	.375	.630	.187
539	.375	.875	.375
540	.375	1.000	.250
545	.375	1.000	.375
550	.375	1.000	.500
555	.375	1.000	.625
594	.375	.500	.380
560	.377	.501	.750
565	.379	.560	.375
570	.380	.625	.750
575	.387	.745	.187
580	.380	.750	.250
585	.380	1.100	.217
590	.383	.750	.437
591	.386	.625	.625
595	.390	.560	.500
599	.390	.625	.250
600	.390	.625	.500
605	.390	.750	.140
610	.403	.750	.312
615	.406	.625	.150
620	.406	.812	.125

SPECIAL NYLON SPACERS

Part Number: C38 + Code (CONTINUED)

CODE	ID	OD	LENGTH
625	.406	1.000	.250
630	.434	.604	.129
635	.437	1.000	.875
640	.460	.750	.250
645	.500	.687	1.375
650	.500	.755	.312
655	.510	.570	.125
660	.510	.750	.188
665	.515	.875	.710
666	.517	1.000	.375
670	.563	1.000	.250
675	.570	.799	.135

CODE	ID	OD	LENGTH
680	.625	1.000	.156
685	.629	1.125	.128
690	.669	1.437	.315
695	.670	1.000	.156
700	.687	1.000	.750
705	.750	1.062	.250
710	.750	1.062	.437
715	.755	1.008	.137
720	.875	1.265	.180
730	1.000	1.500	.500
735	1.150	1.500	.375
740	1.500	1.740	.725

PHENOLIC SPACERS

Part Number: C31 + Code

CODE	SCREW SIZE	LENGTH	OD
001	4	1/4	1/4
002	4	3/8	1/4
003	4	1/2	1/4
004	4	3/4	1/4
005	4	1	1/4
006	6	1/4	1/4
007	6	3/8	1/4
008	6	1/2	1/4
009	6	3/4	1/4
010	6	1	1/4

CODE	SCREW SIZE	LENGTH	OD
011	8	1/4	1/4
012	8	3/8	1/4
013	8	1/2	1/4
014	8	3/4	1/4
015	8	1	5/16
016	10	1/4	5/16
017	10	3/8	5/16
018	10	1/2	5/16
019	10	3/4	5/16
020	10	1	5/16

- Wide range of electrical and mechanical uses: raising chassis, subpanels, transformers
- High dielectric strength for creepless, heavy load use
- Dimensional stability over wide temperature range
- Resists abrasion, wear, moisture and high temperature deterioration

CPVC SPACERS

Part Number: C32 + Code

CODE	SCREW SIZE	LENGTH	ID	OD
001	4	1/4	.120	1/4
002	4	3/8	.120	1/4
003	4	1/2	.120	1/4
004	4	5/8	.120	1/4
005	4	3/4	.120	1/4
006	4	1	.120	1/4
007	6	1/4	.147	1/4
008	6	3/8	.147	1/4
009	6	1/2	.147	1/4
010	6	5/8	.147	1/4
011	6	3/4	.147	1/4
012	6	1	.147	1/4
013	8	1/4	.175	1/4
014	8	3/8	.175	1/4
015	8	1/2	.175	1/4

CODE	SCREW SIZE	LENGTH	ID	OD
016	8	5/8	.175	1/4
017	8	3/4	.175	1/4
018	8	1	.175	1/4
019	8	1/4	.175	3/8
020	8	3/8	.175	3/8
021	8	1/2	.175	3/8
022	8	5/8	.175	3/8
023	8	3/4	.175	3/8
024	8	1	.175	3/8
025	10	1/4	.200	3/8
026	10	3/8	.200	3/8
027	10	1/2	.200	3/8
028	10	5/8	.200	3/8
029	10	3/4	.200	3/8
030	10	1	.200	3/8

- Tolerances $\pm .005$ on all dimensions
- Excellent characteristics for electrical, electronic use
- High dielectric, mechanical strength
- Self-extinguishing; low water absorption
- Resists chemicals, corrosion, high temperature (200°F)

NYLON ROUND THREADED STAND-OFFS/TAPPED SPACERS

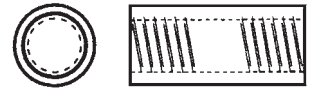

Part Number: C33 + Code

CODE	THREAD	LENGTH	OD
001	4-40	1/4	1/4
002	4-40	3/8	1/4
003	4-40	1/2	1/4
004	4-40	3/4	1/4
005	4-40	1	1/4
006	6-32	1/4	1/4
007	6-32	3/8	1/4
008	6-32	1/2	1/4
009	6-32	3/4	1/4
010	6-32	1	1/4
011	8-32	1/4	1/4
012	8-32	3/8	1/4
013	8-32	1/2	1/4
014	8-32	3/4	1/4
015	8-32	1	1/4
016	8-32	1/4	5/16
017	8-32	3/8	5/16
018	8-32	1/2	5/16

CODE	THREAD	LENGTH	OD
019	8-32	3/4	5/16
020	8-32	1	5/16
021	10-32	1/4	3/8
022	10-32	3/8	3/8
023	10-32	1/2	3/8
024	10-32	3/4	3/8
025	10-32	1	3/8
026	10-32	1/4	1/2
027	10-32	3/8	1/2
028	10-32	1/2	1/2
029	10-32	3/4	1/2
030	10-32	1	1/2
031	1/4-20	1/4	1/2
032	1/4-20	3/8	1/2
033	1/4-20	1/2	1/2
034	1/4-20	3/4	1/2
035	1/4-20	1	1/2

- Tolerances: OD \pm .010, Length \pm .010
- On 3/4" & longer tap is 3/8" from each end and not continuous throughout

NYLON HEX TAPPED SPACERS

Part Number: C39 + Code

CODE	THREAD	LENGTH	HEX SIZE
001	2-56	3/8	3/16
002	2-56	9/16	3/16
003	4-40	1/4	3/16
004	4-40	3/8	3/16
005	4-40	7/16	3/16
006	4-40	1/2	3/16
007	4-40	9/16	3/16
008	4-40	5/8	3/16
009	4-40	3/4	3/16
010	4-40	7/8	3/16
011	4-40	1	3/16
012	6-32	1/4	3/16
013	6-32	3/8	3/16
014	6-32	1/2	3/16
015	6-32	5/8	3/16
016	6-32	3/4	3/16
017	6-32	7/8	3/16
018	6-32	1	3/16
019	4-40	1/4	1/4
020	4-40	5/16	1/4
021	4-40	3/8	1/4
022	4-40	7/16	1/4
023	4-40	1/2	1/4
024	4-40	9/16	1/4
025	4-40	5/8	1/4
026	4-40	3/4	1/4
027	4-40	7/8	1/4

CODE	THREAD	LENGTH	HEX SIZE
028	4-40	1	1/4
029	4-40	1-1/2	1/4
030	6-32	3/16	1/4
031	6-32	1/4	1/4
032	6-32	3/8	1/4
033	6-32	1/2	1/4
034	6-32	5/8	1/4
035	6-32	3/4	1/4
036	6-32	7/8	1/4
037	6-32	1	1/4
038	6-32	1-1/4	1/4
039	8-32	1/4	1/4
040	8-32	3/8	1/4
041	8-32	1/2	1/4
042	8-32	5/8	1/4
043	8-32	3/4	1/4
044	8-32	7/8	1/4
045	8-32	1	1/4
046	6-32	1/2	5/16
047	6-32	1-1/8	5/16
048	1/4-20	7/32	5/16
049	6-32	3/4	3/8
050	6-32	1-5/16	3/8
051	1/4-20	1/2	3/8
052	2-56	5/16	3/16
053	6-32	1/4	7/16

On Threaded Spacers 3/4" & longer tap is 3/8" from each end and not continuous through

PHENOLIC ROUND THREADED STAND-OFFS



Part Number: C34 + Code

CODE	THREAD	LENGTH	OD
001	4-40	1/4	1/4
002	4-40	3/8	1/4
003	4-40	1/2	1/4
004	4-40	3/4	1/4
005	4-40	1	1/4
006	6-32	1/4	1/4
007	6-32	3/8	1/4
008	6-32	1/2	1/4
009	6-32	3/4	1/4
010	6-32	1	1/4

CODE	THREAD	LENGTH	OD
011	8-32	1/4	1/4
012	8-32	3/8	1/4
013	8-32	1/2	1/4
014	8-32	3/4	1/4
015	8-32	1	1/4
016	10-32	1/4	5/16
017	10-32	3/8	5/16
018	10-32	1/2	5/16
019	10-32	3/4	5/16
020	10-32	1	5/16

- Wide range of electrical and mechanical uses: raising chassis, subpanels, transformers
- High dielectric strength for creepless, heavy load use
- Dimensional stability over wide temperature use
- Resists abrasion, wear, moisture and high temperature deterioration

CPVC "SELF THREADING" HEX STAND-OFFS

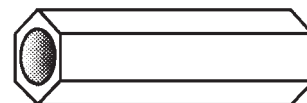

Part Number: C35 + Code

CODE	SCREW SIZE	LENGTH	ID	HEX SIZE
001	4	3/8	.093	3/16
002	4	1/2	.093	3/16
003	4	5/8	.093	3/16
004	4	3/4	.093	3/16
005	4	7/8	.093	3/16
006	4	1	.093	3/16
007	6	1/2	.110	1/4
008	6	5/8	.110	1/4

CODE	SCREW SIZE	LENGTH	ID	HEX SIZE
009	6	3/4	.110	1/4
010	6	7/8	.110	1/4
011	6	1	.110	1/4
012	8	5/8	.141	3/8
013	8	3/4	.141	3/8
014	8	7/8	.141	3/8
015	8	1	.141	3/8

- Easy to apply, low in cost
- "Self-threading" allows assembly with any metal self-tapping screw