

METRIC HEX NUTS

Part Number: K70 + Code

CODE	THREAD SIZE	A/F	THK
001	M2 X 0.4	3.9	1.2
002	M2.5 X 0.45	4.9	1.8
003	M3 X 0.5	5.4	2.2
004	M3.5 X 0.5	6.9	2.7
005	M4 X 0.7	6.9	3.0

CODE	THREAD SIZE	A/F	THK
006	M5 X 0.8	7.9	4.3
007	M6 X 1.0	9.9	5.4
008	M8 X 1.25	12.9	6.4
009	M10 X 1.50	14.8	9.8
010	M12 X 1.75	17.74	10.54

METRIC WASHERS

Part Number: K71 + Code

CODE	SCREW SIZE	OD	ID	THK
001	M3	8.00	3.20	0.80
002	M4	9.00	4.30	0.80
003	M5	11.0	5.30	1.00

CODE	SCREW SIZE	OD	ID	THK
004	M6	12.00	6.40	1.50
005	M8	18.00	8.40	2.00
006	M10	22.00	10.50	2.50

NYLON THREADED STUDS



Part Number: D14 + Code

CODE	THREAD	LENGTH
001	10-32	3/4
002	10-32	1
003	10-32	1-1/2
004	10-32	2
005	10-32	2-1/2
006	1/4-20	3/4
007	1/4-20	1
008	1/4-20	1-1/2
009	1/4-20	2
010	1/4-20	2-1/2

CODE	THREAD	LENGTH
011	1/4-20	3
012	5/16-18	1
013	5/16-18	1-1/2
014	5/16-18	2
015	5/16-18	2-1/2
016	5/16-18	3
017	3/8-16	1
018	3/8-16	1-1/2
019	3/8-16	2

CODE	THREAD	LENGTH
020	3/8-16	2-1/2
021	3/8-16	3
022	3/8-16	4
023	1/2-13	1-1/2
024	1/2-13	2
025	1/2-13	2-1/2
026	1/2-13	3
027	1/2-13	4
028	1/2-13	5

- Injection molded threaded studs with chamfer on both ends are available in several of the most popular sizes and lengths.
- Threaded studs are molded in natural Nylon 6/6 UL 94V2. These studs are resistant to most chemicals, electrically insulating, non-magnetic, lightweight, low thermal conductivity, vibration and abrasion resistant.

STANDARD NYLON HEX NUTS



Part Number: A26 + Code

CODE	THREAD	HEX	THICK
001	2-56	3/16	.062
002	4-40	1/4	.103
003	6-32	5/16	.113
004	8-32	11/32	.142
005	10-32	3/8	.146
006	10-24	3/8	.146
007	1/4-20	7/16	.207

CODE	THREAD	HEX	THICK
008	1/4-28	7/16	.207
009	5/16-18	1/2	.302
012	3/8-16	9/16	.330
014	1/2-13	3/4	.443
015	5/8-11	1.00	.546
016	3/4-10	1-1/8	.635

Single chamfered, washer faced, doublecountersunk

NYLON HEX NUTS (ADDITIONAL SIZES)

Part Number: A27 + Code

CODE	THREAD	HEX	THICK
015	0-80	.187	.047
001	2-56	.180	.090
008	3-48	.180	.070
002	4-40	.250	.124
018	4-40	.180	.070
019	4-40	.250	.100
012	5-40	.250	.093
003	6-32	.305	.146
020	6-32	.305	.120
021	6-40	.305	.120
022	6-40	.312	.113
004	8-32	.340	.170
023	8-32	.335	.130
005	10-24	.365	.196
024	10-24	.365	.135
006	10-32	.365	.196
025	10-32	.420	.135
026	12-24	.425	.207
007	1/4-20	.425	.258
028	1/4-20	.433	.233
030	1/4-28	.433	.235

CODE	THREAD	HEX	THICK
031	1/4-32	.377	.135
032	5/16-18	.500	.270
033	5/16-24	.500	.270
034	5/16-20	.500	.302
035	3/8-16	.560	.330
016	3/8-24	.560	.330
036	3/8-32	.500	.190
037	3/8-32	.560	.330
010	7/16-14	.685	.380
038	7/16-14	.750	.380
039	7/16-20	.685	.380
040	1/2-13	.750	.430
009	1/2-20	.750	.430
041	5/8-11	.925	.550
042	5/8-18	.925	.550
043	11/16-27	1.00	.250
044	3/4-10	1.10	.640
045	3/4-10	1.125	.635
014	13/16-20	1.057	.347
046	7/8-9	1.28	.750
017	1-8	1.47	.870

NYLON HEX JAM NUTS



Part Number: A24 + Code

CODE	THREAD	HEX	THICK
001	5/16-18	.500	.190
002	5/16-24	.500	.190
003	3/8-16	.500	.125
004	3/8-16	.562	.223
005	3/8-16	.670	.219
006	3/8-24	.500	.125
007	3/8-24	.562	.223
008	3/8.32	.500	.125
009	7/16-14	.687	.375
010	7/16-20	.687	.250
012	15/32-32	.625	.125
013	1/2-13	.687	.220
014	1/2-13	.812	.230
015	1/2-24	.687	.220
016	1/2-28	.660	.125
017	9/16-18	.750	.250
018	5/8-11	.930	.375
019	5/8-11	1.00	.286
020	5/8-18	.937	.375
021	5/8-18	1.00	.286
022	3/4-10	1.12	.250
023	3/4-16	1.12	.250
024	3/4-16	1.062	.333
025	3/4-16	1.25	.362
026	3/4-27	1.00	.125
027	7/8-14	1.25	.340

CODE	THREAD	HEX	THICK
028	7/8-14	1.25	.362
029	7/8-14	1.50	.408
030	1-8	1.25	.343
031	1-8	1.48	.410
032	1/8-27 NPT	.560	.110
033	1/8-27 NPT	.550	.220
034	1/8-27 NPT	.562	.225
035	1/4-18 NPT	.680	.255
036	1/4-18 NPT	.740	.187
037	1/4-18 NPT	.812	.230
038	3/8-18 NPT	1.00	.280
039	3/8-18 NPT	1.00	.284
040	1/2-14 NPT	1.25	.340
041	1/2-14 NPT	1.25	.362
042	3/4-14 NPT	1.48	.410
043	3/4-14 NPT	1.50	.404
044	1/8-27 NPS	.562	.225
045	1/4-18 NPS	.687	.225
046	1/4-18 NPS	.812	.230
047	3/8-18 NPS	1.00	.280
048	3/8-18 NPS	1.00	.284
049	1/2-14 NPS	1.25	.340
050	1/2-14 NPS	1.25	.362
051	3/4-14 NPS	1.48	.410
052	3/4-14 NPS	1.50	.404

NYLON HEX LOCK NUTS

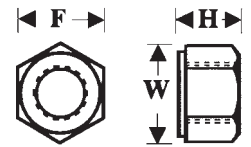

Part Number: A31 + Code

CODE	THREAD	DIMENSIONS		
		F	W	H
001	2-56	3/16	13/64	9/64
002	4-40	1/4	9/32	3/16
003	6-32	5/16	23/64	13/64
004	8-32	11/32	25/64	7/32
005	10-32	3/8	27/64	1/4
006	10-24	3/8	27/64	1/4
007	1/4-20	7/16	1/2	.275
008	1/4-28	7/16	1/2	9/32
010	5/16-18	9/16	21/32	11/32
011	3/8-16	5/8	23/32	13/32
012	7/16-14	13/16	15/16	17/32
013	1/2-13	51/64	59/64	17/32

CODE	THREAD	DIMENSIONS		
		F	W	H
014	5/8-11	15/16	1.050	.570
022	4-40	1/4	9/32	.173
023	6-32	5/16	.388	.196
024	8-32	11/32	.400	.207
025	10-24	3/8	.424	.225
026	10-32	3/8	.430	.230
027	1/4-20	7/16	1/2	.268
028	9/32-32	7/16	.490	.280
029	5/16-24	.555	.640	.340
030	3/8-24	5/8	.715	.406
031	7/16-14	3/4	.852	.462

- Nuts have through tapered threads; begin locking after starting freely for the first turn
- Excellent sealing, locking action
- Can be used with plastic screws not exceeding full nut engagement
- Threads conform to metal screws

PVC HEX NUTS



Part Number: A28 + Code

CODE	THREAD	HEX	THICK
001	2-56	3/16	1/16
002	4-40	1/4	3/32
003	6-32	5/16	7/64

CODE	THREAD	HEX	THICK
004	8-32	11/32	1/8
005	10-32	3/8	1/8
006	10-24	25/64	1/8

PVC HEX NUTS

Part Number: A29 + Code

CODE	THREAD	HEX	THICK
001	1/4-20	7/16	7/32
002	5/16-18	1/2	17/64
003	3/8-16	9/16	21/64

CODE	THREAD	HEX	THICK
004	1/2-13	3/4	7/16
005	5/8-11	15/16	35/64
006	3/4-10	1-1/8	41/64

TEFLON® (TFE) HEX NUTS

Part Number: A30 + Code

CODE	THREAD	HEX	THICK
001	2-56	3/16	1/16
002	4-40	1/4	3/32
003	6-32	5/16	7/64
004	8-32	11/32	1/8
005	10-32	3/8	1/8
006	1/4-20	7/16	7/32

CODE	THREAD	HEX	THICK
007	5/16-18	1/2	17/64
008	3/8-16	9/16	21/64
009	1/2-13	3/4	7/16
010	5/8-11	15/16	35/64
011	10-24	3/8	.120

MOLDED ISOPLAST FLANGED NUTS

Part Number: K38 + Code

CODE	THREAD
001	3/8-16
002	3/8-24
005	1/2-13
006	1/2-20

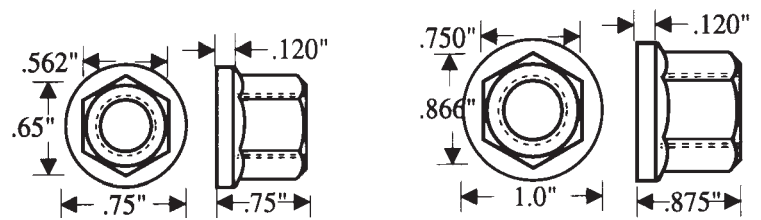

40% Fiberglass filled

MOLDED ISOPLAST HEX NUTS

Part Number: K37 + Code

CODE	THREAD	AF	AC	HEIGHT
001	4-40	1/4	0.354	0.098
002	4-48	1/4	0.354	0.098
003	6-32	5/16	0.442	0.114
004	8-32	11/32	0.486	0.130
005	10-32	3/8	0.530	0.130
006	10-24	3/8	0.530	0.130
007	1/4-20	7/16	0.505	7/32
008	1/4-28	7/16	0.505	7/32
009	5/16-18	1/2	0.577	17/64
010	5/16-24	1/2	0.577	17/64
011	3/8-16	9/16	0.650	21/64
012	3/8-24	9/16	0.650	21/64
013	1/2-13	3/4	0.840	7/16
014	1/2-20	3/4	0.840	7/16
015	5/8-11	15/16	1.083	35/64
016	5/8-18	15/16	1.083	35/64
017	3/4-10	1 1/8	1.299	41/64
018	3/4-16	1 1/8	1.299	41/64
019	7/8-9	1 5/16	1.516	3/4
020	7/8-14	1 5/16	1.516	3/4
021	1-8	1 1/2	1.732	55/64
022	1-12	1 1/2	1.732	55/64
023	1-14	1 1/2	1.732	55/64

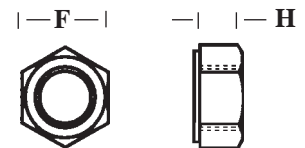

40% Fiberglass filled

NYLON THUMB NUTS



Part Number: A39 + Code

CODE	THREAD	DIAMETER	HEIGHT
001	4-40	5/16	7/32
002	6-32	11/32	21/64
003	8-32	3/8	3/8
004	10-32	13/32	11/32
005	1/4-20	1/2	3/8

- Seals, protects bolt ends; useful as knobs
- Knurled for quick assembly, hand adjustment
- Tolerance: $\pm .015$

NYLON KNURLED THUMB NUTS

Part Number: A40 + Code

CODE	THREAD SIZE	A	B	C
001	4-40	.300	.280	.120
002	6-32	.360	.275	.125
003	8-32	.425	.305	.140
004	10-24	.425	.325	.140
005	10-32	.425	.325	.140
006	1/4-20	.540	.365	.155
007	5/16-18	.612	.400	.170

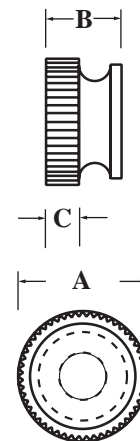

- "A" and "B" tolerances $\pm .010$

NYLON SELF-THREADING LOCK CAP NUTS

Part Number: A32 + Code

CODE	THREAD	HEX SIZE	OVERALL HEIGHT	THREADED HOLE DEPTH
001	4-40	1/4	.286	7/32
002	6-32	1/4	.260	7/32
003	8-32	5/16	.322	1/4
004	10-24	3/8	.385	5/16
005	10-32	3/8	.385	5/16
006	1/4-20	7/16	.478	13/32
007	5/16-18	9/16	.600	1/2

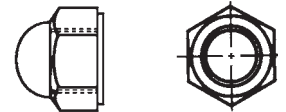

- Have self threaded collars for torque locking action
- Molded threads for easy assembly
- Low cost, excellent strength, toughness, and low weight make them superior to aluminum lock nuts

NYLON HEX LOCK CAP NUTS

Part Number: A33 + Code

CODE	THREAD	HEX	HEIGHT
001	4-40	1/4	17/64
002	6-32	5/16	5/16
003	8-32	5/16	11/32
004	10-32	3/8	3/8
005	10-24	3/8	3/8

CODE	THREAD	HEX	HEIGHT
006	1/4-20	7/16	15/32
007	5/16-18	9/16	17/32
008	3/8-16	5/8	.595
009	7/16-14	13/16	29/32
010	1/2-13	13/16	29/32



- Closed end, washer base, tapered locking threads

NYLON THREADED CAP NUTS

Part Number A34 + Code

CODE	THREAD	HEX	HEIGHT
001	4-40	.250	.280
004	6-32	.305	.345
005	8-32	5/16	.290
006	8-32	.330	.375
007	10-24	5/16	9/32
008	10-24	.365	.400

CODE	THREAD	HEX	HEIGHT
009	10-32	.365	.400
010	1/4-20	.425	.475
011	5/16-18	.500	.530
012	3/8-16	.560	.620
013	1/2-13	.750	.810
014	5/8-11	.935	.970



- Molded & tapped threads

NYLON SOLID WING NUTS

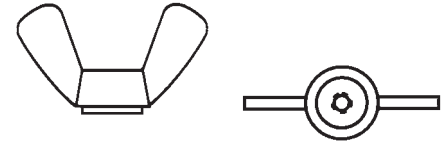

Part Number: A35 + Code

CODE	THREAD	WING SPAN	OVERALL HEIGHT
001	4-40	57/64	1/2
002	6-32	57/64	1/2
003	8-32	57/64	1/2
004	10-24	57/64	1/2
005	10-32	57/64	1/2
006	10-24	1-1/64	5/8
007	10-32	1-1/64	5/8
008	1/4-20	1-1/64	5/8

CODE	THREAD	WING SPAN	OVERALL HEIGHT
009	1/4-28	1-1/64	5/8
010	1/4-20	1-3/8	23/32
011	1/4-28	1-3/8	23/32
012	5/16-18	1-3/8	23/32
013	3/8-16	1-3/8	23/32
014	7/16-14	1-3/4	29/32
015	1/2-13	1-3/4	29/32
016	9/16-12	1-3/4	29/32

NYLON LOCK WING NUTS

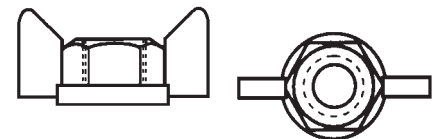

Part Number: A38 + Code

CODE	THREAD	WING SPAN	HEIGHT
001	4-40	.660	.320
002	6-32	.823	.370
003	8-32	.900	.403
004	10-32	1.00	.447
005	10-24	1.00	.447

CODE	THREAD	WING SPAN	HEIGHT
006	1/4-20	1.040	.527
007	5/16-18	1.340	.705
008	3/8-16	1.460	.800
009	7/16-14	1.790	.900
010	1/2-13	1.790	.900

NYLON BLIND SNAP-IN NUTS

Square Head

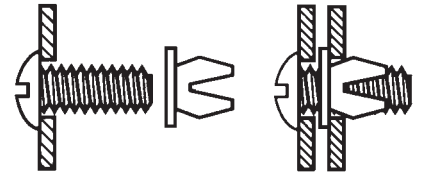

Part Number: B12 + Code

CODE	SELF-TAPPING SCREW SIZE	PANEL HOLE*	PANEL THICKNESS	HEAD SIZE	PRONG LENGTH
001	4	.173-.178	.031-.078	.218 x .050	.218
002	6	.250-.255	.031-.109	.437 x .093	.312
003	6 or 8	.245-.255	.031-.125	.375 x .030	.281
004	8	.265-.281	.031-.156	.375 x .032	.325
005	8	.275-.285	.031-.156	.406 x .032	.325
006	8	.275-.285	.031-.156	.406 x .062	.325
010	12	.375-.380	.031-.109	.625 x .078	.281
012	8 or 10	.275-.290	.031-.125	.375 x .031	.320
013	8 or 10	.275-.290	.031-.125	.375 x .062	.320
014	8 or 10	.275-.290	.031-.125	.375 x .125	.320
015	8 or 10	.275-.290	.031-.125	.375 x .250	.320
016	1/4	.375	.031-.125	.625 x 1.062	.281
017	6	.270	.062-.375	.375 x .031	.435
018	8	.225-.255	.031-.125	.375 x .187	.300
019	6 or 8	.245-.255	.031-.125	.375 x .031	.281
020	6	.250-.255	.110-.125	.375 x .031	.265
021	4	.173-.178	.031-.078	.218 x .250	.218
022	6	.250-.270	.062-.155	.375 x .032	.312
023	8	.285	.078-.175	.380 x .045	.340
024	8 or 10	.275-.280	.040-.045	.370 x .032	.330
025	1/4	.375-.390	.230	.625 x .080	.438
026	8 or 10	.350-.355	.218-.230	.475 x .062	.421
027	10	.370-.390	.064-.187	.609 x .085	.290
028	8	.305-.315	.031-.175	.470 x .060	.300
029	8	.270-.310	.031-.170	.405 x .062	.312
030	10	.310	.031-.170	.465 x .062	.295
031	10	.320	.031-.155	.650 x .072	.305
032	2	.245-.270	.047-.095	.375 x .032	.240
033	8	.335-.340	.062-.125	.512 x .075	.315
034	6	.270	.062-.125	.390 x .050	.275
035	4	.275-.285	.031-.125	.375 x .050	.218
036	6	.200-.270	.032-.156	.312/.437 x .035	.312
037	6	.275-.280	.062-.120	.390 x .055	.281
038	6	.260-.270	.093-.187	.410 x .040	.310
039	8	.265	.047-.180	.375 x .032	.327

*PANEL HOLE SIZE:

- Will vary slightly depending on panel thickness; write for recommendations on your particular application
- Burr side of hole should be opposite grommet entry

NYLON BLIND SNAP-IN NUTS

Square Head (continued)

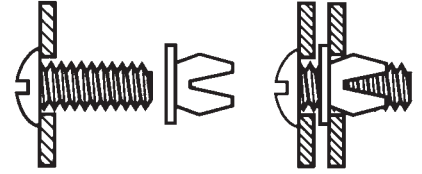

Part Number: B12 + Code

CODE	SELF-TAPPING SCREW SIZE	PANEL HOLE*	PANEL THICKNESS	HEAD SIZE	PRONG LENGTH
040	1/4	.365	.062-.120	.625 x .080	.281
041	1/4	.370-.375	.062-.120	.625 x .080	.281
042	1/4	.410	.031-.062	.630 x .140	.280
043	10	.320-.335	.032-.234	.470 x .055	.420
044	10	.335-.345	.062-.171	.468 x .095	.400
045	8	.330-.365	.032-.095	.500 x .094	.295
046	6	.250-.260	.062-.125	.375 x .140	.265

NYLON BLIND SNAP-IN NUTS

Round Head

Part Number: B12 + Code

CODE	SELF-TRAPPING SCREW SIZE	PANEL HOLE*	PANEL THICKNESS	HEAD SIZE	PRONG LENGTH
007	8	.275-.285	.031-.156	.500 x .130	.325
008	8 or 10	.281-.286	.031-.109	.500 x .375	.281
009	1/4	.330-.343	.031-.156	.562 x .062	.325
011	5/16	.425-.430	.031-.109	.750 x .187	.312
047	6	.270-.280	.062-.165	.375 x .093	.297
048	8 or 10	.275-.290	.031-.125	.500 x .031	.320
049	8 or 10	.271-.290	.031-.125	.500 x .062	.320
050	8 or 10	.271-.290	.031-.125	.500 x .125	.320
051	8 or 10	.275-.290	.031-.125	.500 x .250	.320
052	8	.275-.290	.031-.156	.500 x .375	.320
053	8 or 10	.275-.290	.031-.156	.500 x .708	.315
054	6	.280-.285	.032-.150	.500 x .719	.344
055	8 or 10	.275-.290	.031-.125	.437 x .032	.325
056	8 or 10	.275-.290	.031-.109	.547 x 1.062	.281
057	8	.285-.290	.031-.094	.455 x 1.505	.275
058	12	.350-.355	.032-.125	.531 x .125	.281
059	10	.310	.031-.160	.500 x .035	.292
060	1/4	.415-.430	.032-.135	.750 x .062	.310
061	10	.325-.330	.031-.156	.565 x .062	.320
062	8	.275	.062-.170	.495 x .312	.325