

## NYLON CABLE TIES



**Part Number: K77 + Code**

### MINIATURE 18 POUND SERIES

CODE	COLOR	LENGTH (INCHES)	WIDTH (INCHES)	BUNDLE DIAM. (INCHES)	MILITARY SPEC
001	Natural	3.1	.10	.68	-
002	Black	3.1	.10	.68	-
003	Natural	4.0	.10	.75	MS3367-4-9
004	Black	4.0	.10	.75	MS3367-4-9
005	Natural	6.0	.10	1.25	-
006	Black	6.0	.10	1.25	-
007	Natural	8.0	.10	2.0	-
008	Black	8.0	.10	2.0	-

### INTERMEDIATE 40 POUND SERIES

CODE	COLOR	LENGTH (INCHES)	WIDTH (INCHES)	BUNDLE DIAM. (INCHES)	MILITARY SPEC
009	Natural	5.7	.14	1.25	MS3367-5-9
010	Black	5.7	.14	1.25	MS3367-5-9
011	Natural	8.1	.14	2.0	-
012	Black	8.1	.14	2.0	-
013	Natural	11.2	.15	3.0	-
014	Black	11.2	.15	3.0	-
015	Natural	14.5	.15	4.0	-
016	Black	14.5	.15	4.0	-

### STANDARD 50 POUND SERIES

CODE	COLOR	LENGTH (INCHES)	WIDTH (INCHES)	BUNDLE DIAM. (INCHES)	MILITARY SPEC
017	Natural	6.3	.18	1.5	-
018	Black	6.3	.18	1.5	-
019	Natural	8.0	.19	2.0	MS3367-1-9
020	Black	8.0	.19	2.0	MS3367-1-0
021	Natural	9.9	.19	2.6	-
022	Black	9.9	.19	2.6	-
023	Natural	11.8	.19	3.0	MS3367-7-9
024	Black	11.8	.19	3.0	MS3367-7-0
025	Natural	14.6	.19	4.0	MS3367-2-9
026	Black	14.6	.19	4.0	MS3367-2-0
027	Natural	17.0	.19	5.0	-
028	Black	17.0	.19	5.0	-

## NYLON CABLE TIES (CONTINUED)



**Part Number: K77 + Code**

### LIGHT HEAVY 120 LB SERIES

CODE	COLOR	LENGTH (INCHES)	WIDTH (INCHES)	BUNDLE DIAM. (INCHES)	MILITARY SPEC
029	Natural	7.9	.30	2.0	-
030	Black	7.9	.30	2.0	-
031	Natural	11.9	.30	3.0	-
032	Black	11.9	.30	3.0	-
033	Natural	14.5	.30	4.0	MS3367-3-9
034	Black	14.5	.30	4.0	MS3367-3-9
035	Natural	21.3	.30	5.6	-
036	Black	21.3	.30	5.6	-

### HEAVY 175 POUND SERIES

CODE	COLOR	LENGTH (INCHES)	WIDTH (INCHES)	BUNDLE DIAM. (INCHES)
037	Natural	17.0	.35	4.9
038	Black	17.0	.35	4.9
039	Natural	20.7	.35	5.5
040	Black	20.7	.35	5.5
041	Natural	24.9	.35	7.0
042	Black	24.9	.35	7.0
043	Natural	32	.35	9.4
044	Black	32	.35	9.4
045	Natural	36.5	.35	10.7
046	Black	36.5	.35	10.7
047	Natural	48	.35	15
048	Black	48	.35	15

### EXTRA HEAVY 250 POUND SERIES

CODE	COLOR	LENGTH (INCHES)	WIDTH (INCHES)	BUNDLE DIAM. (INCHES)
049	Natural	17.0	.50	4.9
050	Black	17.0	.50	4.9
051	Natural	22	.50	6.0
052	Black	22	.50	6.0
053	Natural	34	.50	10.1
054	Black	34	.50	10.1
055	Natural	40	.50	12.1
056	Black	40	.50	12.1

## PLAIN WIRE TIES



### Part Number: K78 + Code

CODE	LENGTH
001	4
002	6
003	8
004	10

- Stocked in Natural Nylon
- Polypropylene available on request; minimum will apply

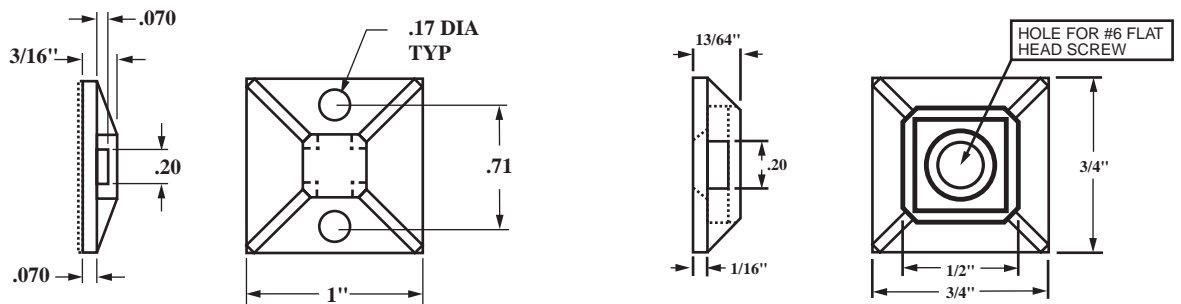

## NYLON CABLE TIE MOUNT NATURAL COLOR

### Part Number: K25 + Code

CODE	PART	SIZE (SQUARE)	STYLE
001	08-461	3/4	Adhesive Backed for 4" Ties
002	08-462	1	Adhesive Backed for 7"-11" Ties
003	08-463	1	Plain Back for 7"-11" Ties

## CABINET FEET WITH NICKLE-PLATED STEEL INSERTS

The TPR Plastic Cabinet Feet with Nickle-plated Steel Inserts are designed for longer life and to take greater loads than all-plastic feet, because the screw load is absorbed by the insert. Can also be used as bumpers with the same advantage.

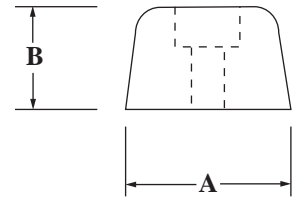

### Part Number: K20 + Code

CODE	MACHINE SCREW SIZE	DIMENSIONS	
		A	B
001	4	.562	.375
002	6	.750	.437
003	8	.937	.625
005	10	1.125	.875
006	10	1.250	1.125
007	4	.625	.312
008	6	.750	.375
009	6	.875	.437

CODE	MACHINE SCREW SIZE	DIMENSIONS	
		A	B
010	8	1.062	.531
011	10	1.250	.625
012	6	.687	.250
013	8	.875	.312
014	10	1.062	.437
015	10	1.312	.500
016	10	1.625	.562

## COMPONENT CLIPS

### Part Number: K23 + Code

CODE	DIA. OF PART TO BE HELD	CLIP LENGTH
001	1/4	1/2
002	5/16	1/2
003	3/8	1/2
004	7/16	1/2
005	1/2	1/2
006	9/16	1/2
007	5/8	1/2
008	11/16	1/2
009	3/4	1/2
010	7/8	1/2
011	1	1-1/8 (2 mounting holes)
012	1-3/8	1-1/8 (2 mounting holes)

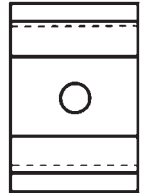
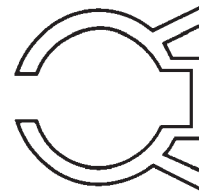

- Holds, protects and insulates electrical components
- Clips permit fast and easy insertion and removal
- Holds parts firmly
- Black PVC
- 3/32" Dia. Mounting Hole for 1/4" thru 5/8" Part Size
- 5/32" Dia. Mounting Hole for 11/16" thru 1-3/8" Part Size

## NYLON PLAIN EDGE CABLE CLAMPS

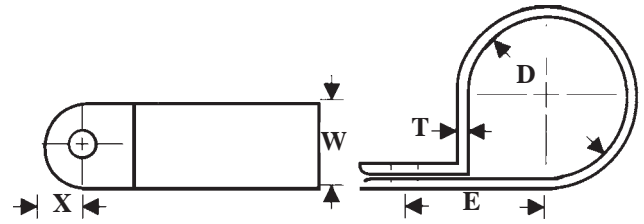

Part Number: K35 + Code

CODE	D1 CLOSED DIAMETER (INCHES)	E (INCHES)	T THICKNESS (INCHES)	W WIDTH (INCHES)	H HOLE DIAMETER (INCHES)	X (INCHES)
001	.125	.329	.050	.375	.170	.218
002	.187	.430	.050	.375	.170	.218
003	.250	.410	.050	.375	.170	.218
004	.312	.495	.050	.375	.170	.218
005	.375	.595	.050	.375	.170	.218
006	.437	.574	.050	.375	.170	.218
007	.500	.605	.050	.375	.170	.218
008	.125	.329	.050	.375	.203	.218
009	.187	.378	.050	.375	.203	.218
010	.250	.410	.050	.375	.203	.218
011	.312	.495	.050	.375	.203	.218
012	.375	.595	.050	.375	.203	.218
013	.437	.574	.050	.375	.203	.218
014	.500	.605	.050	.375	.203	.218
015	.250	.410	.060	.500	.203	.218
016	.312	.500	.060	.500	.203	.218
017	.375	.530	.060	.500	.203	.218
018	.437	.560	.060	.500	.203	.218
019	.500	.595	.060	.500	.203	.218
020	.562	.606	.060	.500	.203	.218
021	.625	.655	.060	.500	.203	.218
022	.687	.755	.060	.500	.203	.218
023	.750	.780	.060	.500	.203	.218
024	.812	.815	.060	.500	.203	.218
025	.875	.845	.060	.500	.203	.218
026	1.000	.910	.060	.500	.203	.218
027	1.125	.970	.060	.500	.203	.218
028	1.187	1.00	.060	.500	.203	.218
029	1.250	1.060	.060	.500	.203	.218
030	1.375	1.125	.060	.500	.203	.218
031	1.500	1.190	.060	.500	.203	.218
TOLERANCES	±.010	±.030	±.005	±.015	±.010	±.030